

SHEPHERD

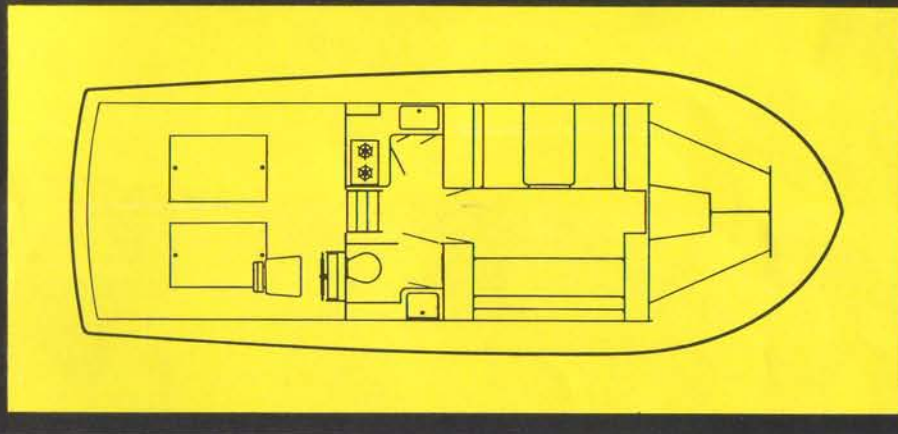



SHEPHERD

MODEL 180 • 33 FOOT FLYING BRIDGE CRUISER

For those with discriminating boating taste, this magnificent new Shepherd is the ultimate in luxury living afloat. Advanced engineering and styling plus Shepherd's tradition of craftsmanship make this 33 footer the boat of the year.



SHEPHERD

MODEL 155A AND MODEL 160 H.T. • 30 FOOT EXPRESS CRUISER

Handsome it is—and just the boat for overnight cruises or daytime fun! This hardtop is perfect for family boating. Fitted from stem to stern in the best Shepherd tradition, you'll find this twin-powered beauty a thrill to drive and own.

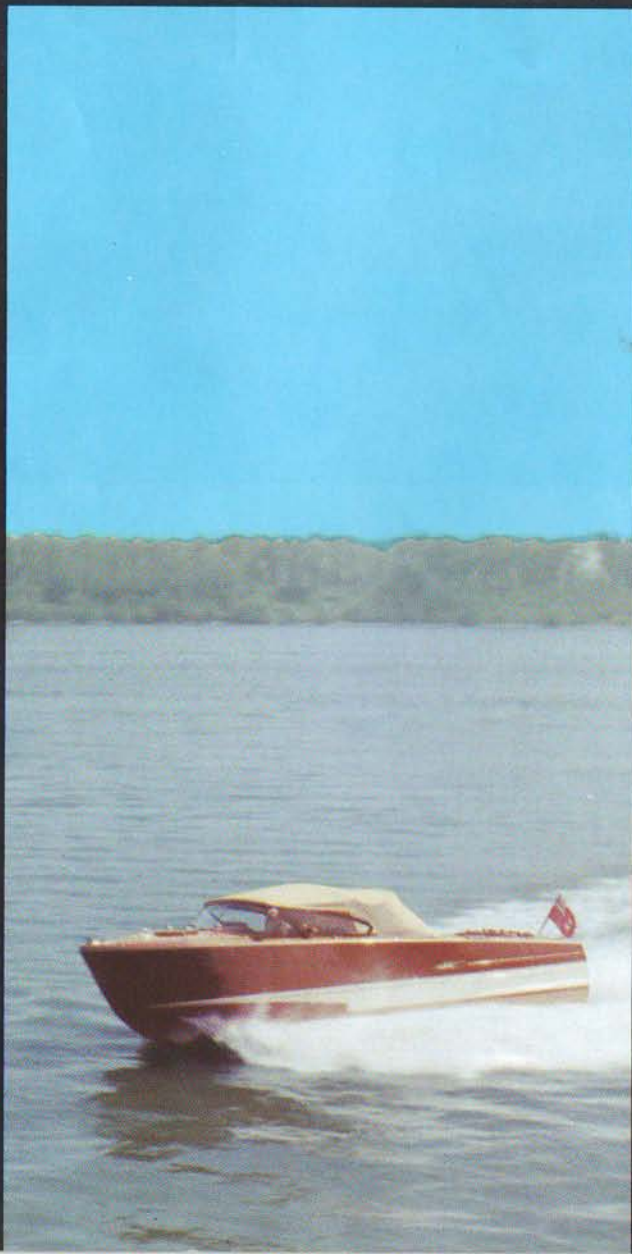
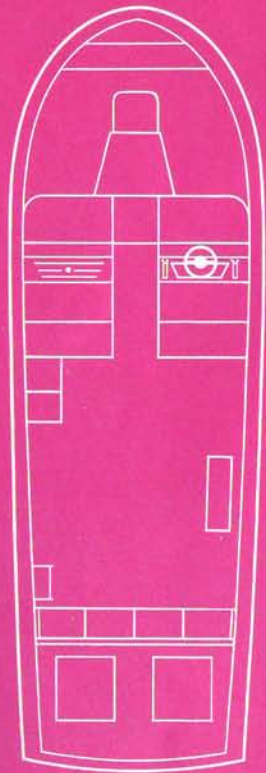

CRAFTSMANSHIP



SHEPHERD

MODEL 130 AND MODEL 150 • 27 FOOT

Express Cruiser and Hardtop.

This 27 foot Shepherd
gives the flexibility you want
in an open sports model . . .

450 horsepower, provides speeds
up to 39 miles per hour.



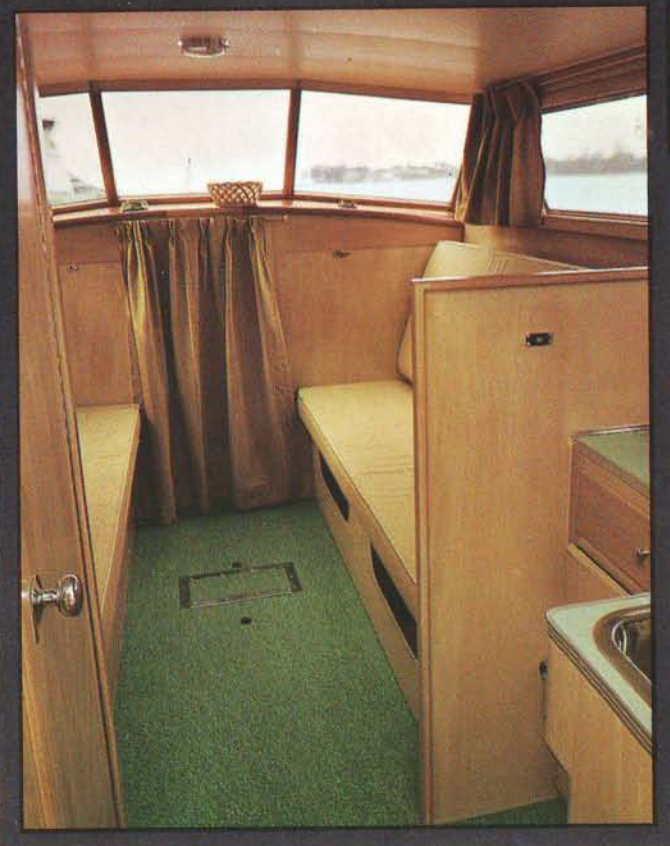
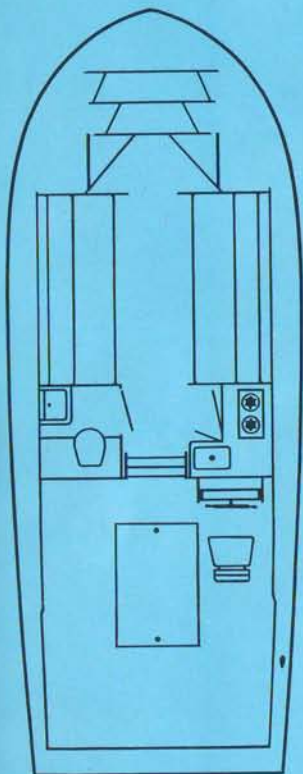

SHEPHERD

MODEL 170 • 25 FOOT FLYING BRIDGE CRUISER

Sparkling water, surging foam, and the thrill of power
at your fingertips—a dream fulfilled with Shepherd's new 25-footer!

Its hand-scraped hull glistens with 5 coats of hand-rubbed varnish, a touch of
luxury only associated with the best.



SHEPHERD

MODEL 100 AND MODEL 105 • 19 FOOT

A 19 foot beauty to carry you into flights of fancy with a 275 h.p. engine to fulfil the promises implied by its dynamic mahogany hull.

A spirited sportster for the sheer joy of carefree boating . . .

a sense of fulfilment is yours knowing that you have the ultimate in performance at your fingertips.





SHEPHERD

MODEL 110 • 22 FOOT

Every detail of design and construction has been carefully considered to give you a thrill-packed boat that leaves nothing to be desired . . . advanced engineering and exciting design combined for your boating pleasure.



MODEL 75 AND MODEL 80 • 16 FOOT INBOARD

The accent is on good taste with this beautifully appointed 16 foot inboard. An easy-to-handle craft that's the perfect answer if a quick-to-respond, ready-for-action boat is what you are after. Climb aboard to endless pleasure.



SHEPHERD



MODEL 55 • 16 FOOT OUTBOARD

This is where you belong . . . at the controls of this top-horsepower outboard! A peppy 16 footer that's designed for maximum efficiency and outfitted in a way that will make you proud to be its owner. Up to 38 m.p.h. is yours when you step into this boating beauty.



SPECIFICATIONS

| | Length | Beam | Moulded depth | Draft | Freeboard fore and aft | Bottom | Sides | Deck | Seats | Controls — gear shift | Engine | Weight (approx.) | Speed (approx.) | Frames and battens | Stem and keel | Fastenings | W |
|---|---------|---------------|---------------|-------|------------------------|--------------------|-------------------------|--|---|-----------------------|---|----------------------------------|-------------------|-------------------------------|-------------------------|------------------------------|---------------------------|
| Model 55 16' O/B | 16 ft. | 6 ft. 4 ins. | 37" | 24" | 25½"-18" | ¾" mahog. — double | ¾" batted seamed mahog. | ¾" Honduras mahog. | full back seat, split front; seats 5 | | top horsepower | 650 lbs. | up to 38 | selected white oak and mahog. | selected oak and mahog. | brass screws and galv. bolts | Flexi moul top a |
| Model 75 Vee Dr. Model 80 D.D. 16' Inboard | 16½ ft. | 6 ft. 4 ins. | 37" | 25" | 25½"-22" | ¾" mahog. — double | ¾" batted seamed mahog. | ¾" Honduras mahog. | full back seat, split front; seats 5 full front seat with D.D. | manual | 110 h.p. Chrysler Vee Dr. Gray 109 D.D. | 1600 lbs. | up to 40 | selected white oak and mahog. | selected oak and mahog. | brass screws and galv. bolts | Flexi moul top a |
| Model 100 D.D. Model 105 Vee Dr. 19 ft. | 19 ft. | 6 ft. 9 ins. | 44½" | 25" | 26½"-20½" | ¾" mahog. — double | ¾" batted seamed mahog. | ¾" Honduras mahog. | full back seat, split front; seats 5 | manual and hydraulic | up to 275 h.p. | 1900 lbs. | up to 48 | selected white oak and mahog. | selected oak and mahog. | brass screws and galv. bolts | glass corn |
| Model 110 22 ft. Vee Dr. or D.D. | 22 ft. | 7 ft. 4 ins. | 52½" | 26" | 34½"-24" | ¾" mahog. — double | ¾" batted seamed mahog. | ¾" Honduras mahog. | full back seat, split front; seats 5 | manual and hydraulic | up to 275 h.p. | 3000 lbs. | up to 44 | selected white oak and mahog. | selected oak and mahog. | brass screws and galv. bolts | glass corn |
| Model 170 25 ft. F.B. Cruiser D. Dr. | 25 ft. | 9 ft. 4 ins. | 66" | 27" | 45½"-37" | ½" mahog. — double | ¾" batted seamed mahog. | ¾" mahog. decking plus ¼" plywood underlay forward | 1 helmsman seat 2 settees; convert to bunks | hydraulic | twin engines up to 354 h.p. | 5900 lbs. | single 32 twin 38 | selected white oak and mahog. | selected oak and mahog. | brass screws and galv. bolts | Adju Vent Plate Wind |
| Model 130 Model 150 27 ft. Express Cruiser and H.T. | 27 ft. | 9 ft. 4 ins. | 66" | 30" | 46"-34" | ½" mahog. — double | ¾" batted seamed mahog. | ¾" mahog. decking plus ¼" plywood underlay forward | full back seats, two front seats | hydraulic | twin engines up to 450 h.p. | Express 7500 lbs. H.T. 7900 lbs. | up to 39 | selected white oak and mahog. | selected oak and mahog. | brass screws and galv. bolts | Flexi moul corn |
| Model 155A Model 160 H.T. 30 ft. Express Cruiser | 30 ft. | 9 ft. 10 ins. | 67¼" | 30" | 49"-38" | ½" mahog. — double | ¾" batted seamed mahog. | ¾" mahog. decking plus ¼" plywood underlay forward | two front seats, one full back seat | hydraulic | twin engines up to 550 h.p. | Express 7700 lbs. H.T. 8100 lbs. | up to 39 | selected white oak and mahog. | selected oak and mahog. | brass screws and galv. bolts | Flexi moul corn |
| Model 180 33 ft. F.B. Cruiser | 33 ft. | 11 ft. 9 ins. | 81¼" | 30" | 60"-45" | ½" mahog. — double | ¾" batted seamed mahog. | ½" Teak decking plus ½" plywood underlay forward | 1 helmsman seat, 1 settee | hydraulic | twin engines up to 450 h.p. | 8900 lbs. | up to 35 | selected white oak and mahog. | selected oak and mahog. | brass screws and galv. bolts | Adju Vent Plate Wind F.B. |

Standard Equipment

Model 55

lifting rings fore and aft; unicleats; cleats; sheer mouldings; running lights; chocks; sheaves; L.H. glove compartment; Garboard drain; self draining well; hatch on aft deck

Models 80 and 75

lifting rings fore and aft; unicleats; cleats; sheer mouldings; running lights; chocks; two transom vents, Vee Dr. one on D.D.; Garboard drain

Models 100 and 105

lifting rings fore and aft; unicleats; cleats; sheer mouldings; running lights; chocks; 2 pr. step-plates; electric horn; two chrome transom vents; Vee Dr. one on D.D.; Garboard drain; Vent windows; 2 mahog. liquor cabinets with fold down table tops; cutwater; padded dashboard

Model 110

lifting rings fore and aft; cleats; sheer mouldings; running lights; unicleats; 2 pr. step-plates; electric horn; chocks; cutwater; two chrome transom vents; Garboard drain; Vent windows; 2 mahogany liquor cabinets with fold down door which form table tops

Model 170

sleeping capacity 4 standard, electric bilge pump; electric horn; running lights; 6-instrument panel; (two temp. gauges); galley complete with stove and ice box; Garboard drain; mirror installed on enclosed head; one helmsman seat; cabin hand rails; teak rear deck; folding table; screens & drapes; window in cabin door, gates in both rails; Adjustable Vent safety plate glass windows in F.B. windshield; Bow lifting ring and stern lifting sockets

| Instrument Panel | Gasoline Tank - Stainless Steel | Rudder & Propeller | Strut | Shaft | Shaft log | Steering | Steering Wheel | Floor covering | Headroom | Throttle control | Upholstery | Seat Cushions | Hardware | Flagpole | Finish |
|---|--|--------------------|--|--------------|--------------------------|----------------------------|-----------------------|-----------------|-----------|------------------------------|------------------------|---------------------------|--|----------------|---|
| | optional | | | | | Cable | DeLuxe with horn ring | rubber | | | Vinyl-jersey backed | Resilitex | chrome-plated brass and die cast alum. | chrome lighted | deck, topsides, transom, inside lining varnished and painted; bottom inside oil treated and painted; bottom outside painted with anti-fouling copper bronze |
| lighted; tachometer, gas, ammeter, oil, water temp.; chrome ignition switch, starter button, choke and light switches | 16½ Imp. gals. | manganese bronze | manganese bronze with Aqualite bearing | Tobin bronze | bronze with Syntron Seal | R.H. drag link | Deluxe with horn ring | rubber | | R.H. side of steering column | Vinyl-jersey backed | Resilitex | chrome-plated brass and die cast alum. | mahog. lighted | deck, topsides, transom, inside lining varnished and painted; bottom inside oil treated and painted; bottom outside painted with anti-fouling copper bronze |
| lighted; tachometer, gas, ammeter, oil, water temp., chrome ignition switch, lighter, starter button, choke, light and nameplates | 21 Imp. gals. | manganese bronze | manganese bronze with Aqualite bearing | Tobin bronze | bronze with Syntron Seal | R.H. drag link | DeLuxe with horn ring | Vinyl Carpeting | | L.H. side of steering column | Vinyl-jersey backed | foam rubber and Resilitex | brass, chrome-plated | mahog. lighted | deck, topsides, transom, inside lining varnished and painted; bottom inside oil treated and painted; bottom outside painted with anti-fouling copper bronze |
| lighted; tachometer, gas, ammeter, oil, water temp., chrome ignition switch, lighter, starter button, choke, light and nameplates | 30 Imp. gals. | manganese bronze | manganese bronze with Aqualite bearing | Tobin bronze | bronze with Syntron Seal | R.H. drag link | DeLuxe with horn ring | Vinyl Carpeting | | L.H. side of steering column | Vinyl-jersey backed | foam rubber and Resilitex | brass, chrome-plated | mahog. lighted | deck, topsides, transom, inside lining varnished and painted; bottom inside oil treated and painted; bottom outside painted with anti-fouling copper bronze |
| lighted; tachometer, fuel, ammeter, oil, water temp., ignition and starter switches; lighter, appropriate light switches and nameplates | single eng. 46 Imp. gals. twin 2-30 Imp. gals. | manganese bronze | manganese bronze with Aqualite bearing | Tobin bronze | bronze with Syntron Seal | Rack and Pinion with cable | ship's wheel | Vinyl Carpeting | cabin 74" | on instrument panel | settees — fabric cloth | settees — foam | brass, chrome-plated | mahog. lighted | deck, topsides, transom, inside lining varnished and painted; bottom inside oil treated and painted; bottom outside painted with anti-fouling copper bronze |
| lighted; tachometer, fuel, ammeter, oil, water temp., ignition and starter switches, lighter, appropriate light switches and nameplates | 2-46 Imp. gals. | manganese bronze | manganese bronze with Aqualite bearing | Tobin bronze | bronze with Syntron Seal | R.H. drag link | DeLuxe with horn ring | Vinyl Carpeting | H.T. 74" | on instrument panel | Vinyl-jersey backed | foam rubber and Resilitex | brass, chrome-plated | mahog. lighted | deck, topsides, transom, inside lining varnished and painted; bottom inside oil treated and painted; bottom outside painted with anti-fouling copper bronze |
| lighted; tachometer, fuel, ammeter, oil, water temp., ignition and starter switches, lighter, appropriate light switches and nameplates | 2-46 Imp. gals. | manganese bronze | manganese bronze with Aqualite bearing | Tobin bronze | bronze with Syntron Seal | R.H. drag link | DeLuxe with horn ring | Vinyl Carpeting | H.T. 74" | on instrument panel | Vinyl-jersey backed | foam rubber and Resilitex | brass, chrome-plated | mahog. lighted | deck, topsides, transom, inside lining varnished and painted; bottom inside oil treated and painted; bottom outside painted with anti-fouling copper bronze |
| lighted; tachometer, fuel, ammeter, oil, water temp., ignition and starter switches, lighter, appropriate light switches and nameplates | 2-46 Imp. gals. | manganese bronze | manganese bronze with Aqualite bearing | Tobin bronze | bronze with Syntron Seal | Rack and Pinion with cable | Ship's wheel | Vinyl Carpeting | 78" | on instrument panel | settees — fabric cloth | foam rubber and Resilitex | brass, chrome-plated | mahog. lighted | deck, topsides, transom, inside lining varnished and painted; bottom inside oil treated and painted; bottom outside painted with anti-fouling copper bronze |

and 150
 pump; electric bilge blower;
 toilet; plastic hand basin, twin
 horns; chocks; step-plates; H.T.; cabin
 deck rails; sheer mouldings;
 motor compartment, insulated;
 compartment insulated; twin spotlights;
 sound proofing in H.T.; drop
 Garboard drain

Model 155A
 automatic electric bilge pump; electric bilge
 blower; hand operated toilet; plastic hand
 basin; twin horns; cleats; chocks; step-plates;
 H.T. slide windows; H.T. cabin rails; hand deck
 rails; sheer mouldings; running lights; motor
 compartment insulated; twin spotlights;
 sound proofing in H.T.; drop leaf table;
 Garboard drain

Model 180
 automatic electric bilge pump; fresh water circulating
 pump; electric bilge blower; Marmac motor controls;
 hydraulic hand operated toilet; plastic hand basin;
 cleats; chocks; step-plates; cabin hand rails; sheer
 mouldings; running lights (class 2); twin electric
 trumpet horns; stern and bow springline bits; motor
 compartment insulated; cabin lights; sliding windows;
 cabin ceiling soundproofed; mahog. mast (class 2);
 light mahog. flagpole bow and stern; Garboard drain;
 Dinette — convert to double berth; screens & drapes;
 teak decks, fore, aft & sides; Convertible top; deluxe
 helmsman's chair, dish rack; Bow lifting ring &
 stern lifting sockets

Abbreviations: O/B — Outboard
 D.D. — Direct Drive
 Vee Dr. — V-Drive
 F.B. — Flying Bridge
 H.T. — Hard Top
 h.p. — Horsepower
 R.H. — Right Hand
 L.H. — Left Hand

Specifications subject to change without notice

SHEPHERD BOATS LIMITED NIAGARA-ON-THE-LAKE ONTARIO CANADA

